

Industrial LED fittings with the highest IP ratings

SELENE

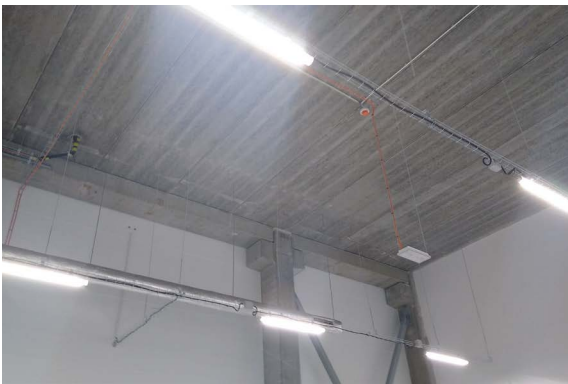

Up to 90% savings in energy costs

Power from 25 W to 70 W

Rating IP67 (options: IP68 and IP69K)

Optionally dimmable (DALi or 0-10V)

Compatible with motion detectors and light sensors

High quality and reliability

Manufactured in EU

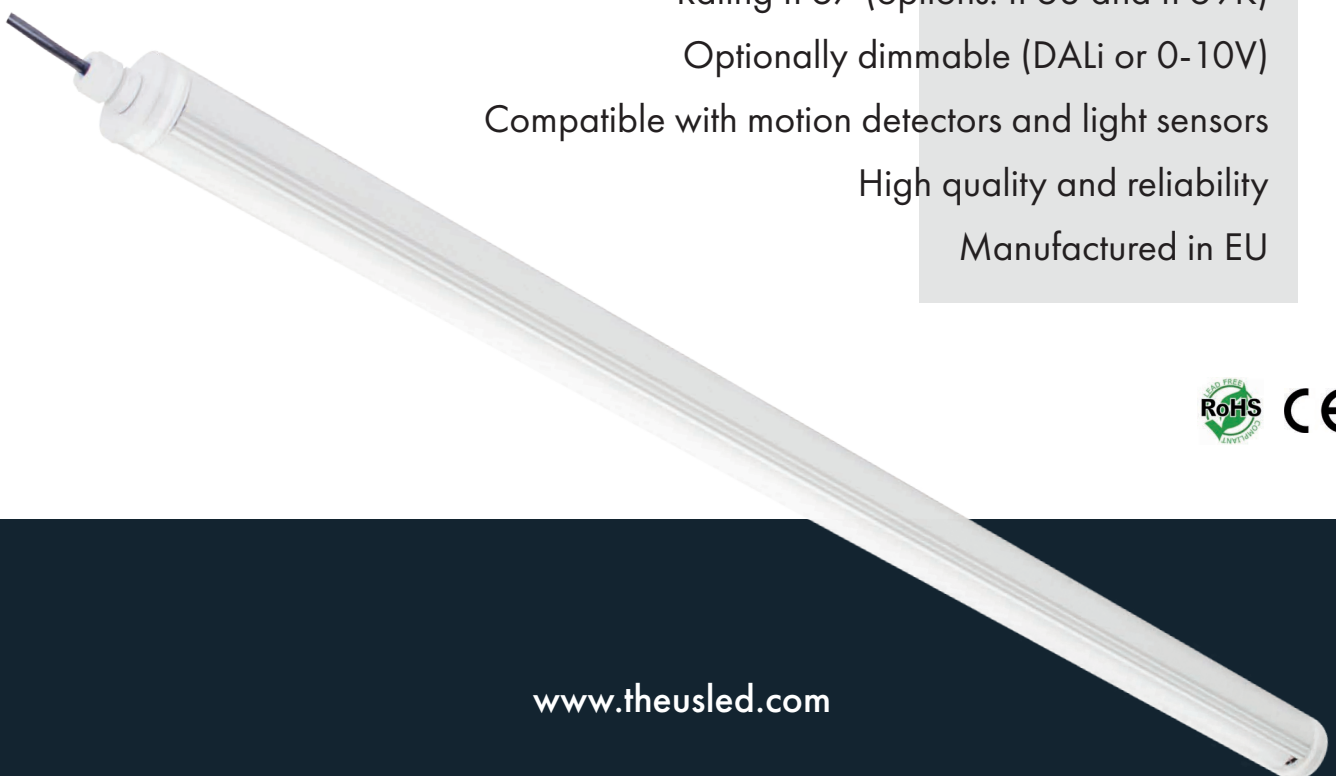

SOLUTIONS FOR:

Heavy duty dirt and / or humidity work stations
Production halls, warehouses with the highest sanitary standards (food&beverages, pharmacy, automotive)

Maximum savings

- High light output (4 100 – 12 700 lm)
- LED efficiency up to 220 lm/W
- Versions with DALI or 0-10 Venable cooperation with automation systems
- Glass free, unbreakable fixture (PMMA or PC)
*Optional body made of borosilicate glass.

Customer satisfaction and safety

- Production in EU
- Short lead times
- Quality construction for long life operation
- 5 years warranty
- High Color Rendering Index Ra > 80
- ESD protected
- Top quality components provided by reputable manufacturers
- Steady light stream with no stroboscopic effect.

Convenience and comfort for installers and maintainers

- Professional support
- Easy installation
- Low operating costs
- Optional external quick connector
- Optional through-wiring.





Technical parameters

Light source	LEDs	Operating temperatures (ta)	-25°C to +45°C
LED lifetime	L70 > 260 000 h (ta = 25°C)	IP class	IP67 (options IP69K)
Color temperatures	4000 K (others available on request)	Electrical insulation class	cl. II
Color Rendering Index	Ra > 80 (higher on request)	Power factor	cos Φ > 0,98
Voltage	198 – 264 VAC 24V AC/DC (optional)	Power supply efficiency	η > 88%
		Brightness control	DALI/0-10 V (options)

Dimensions and weight



H – height of the luminaire with additional fixing element
f – tube diameter
W – width of the luminaire with handles

	f*)	H*)	L**)	W	weight
Fixture type	[mm]	[mm]	[mm]	[mm]	[kg]
SL2-PSP b K1...	50/56	68/80	620	68	1,2
SL2-PSP b S1...	50/56	68/80	1076	68	1,7
SL2-PSP b D1...	50/56	68/80	1480	68	2,4

*) tube: PMMA or PC / borosilicate glass

**) external quick connectors increase the length of the fitting respectively 20 mm (one-sided) and 46 mm (two-sided)

Industrial LED fittings with the highest IP ratings

SELENE

Fixture power table

Luminaire version	SL2-025NK1 (26 W, L = 610 mm)	SL2-055NS1 (54 W, L = 1070 mm)	SL2-070ND1 (71 W, L = 1480 mm)
Light output Optics P only	4 100 lm	8 600 lm	12 150 lm
Equivalent of	T8 fluorescent bulb 1 x 58 W	T8 fluorescent bulb 2 x 58 W	T8 fluorescent bulb 3 x 58 W
Application	Heavy duty dirt and/or humidity work stations, production halls, warehouses with the highest sanitary standards (food&beverages, pharmacy, automotive)		

The luminaires' power ratings and exemplary applications are indicative and relate to open halls. Specific types of luminaires are selected on the basis of the lighting design.

Light distribution curve adjustment

Using combinations of different optical systems in one fixture allows to meet design requirements of the user. Light distribution curves for optics P, C, D, E, L:

P100 (108° x 110°) (PMMA; CLEAR)

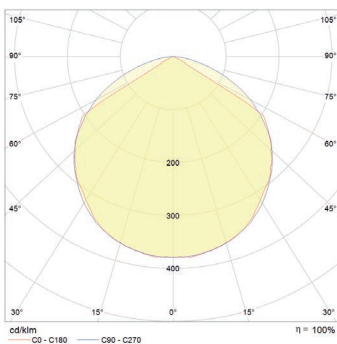

P1C1 (57° x 124°) (PMMA; CLEAR)

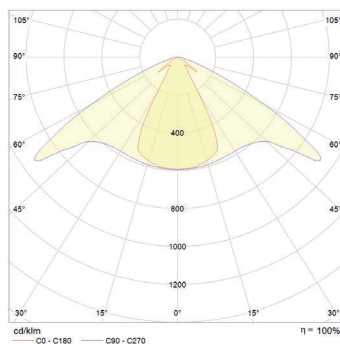

P1D1 (33° x 113°) (PMMA; CLEAR)

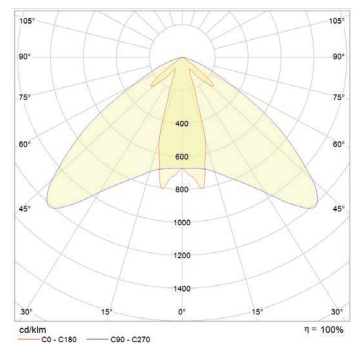

P1E1 (13° x 79°) (PMMA; CLEAR)

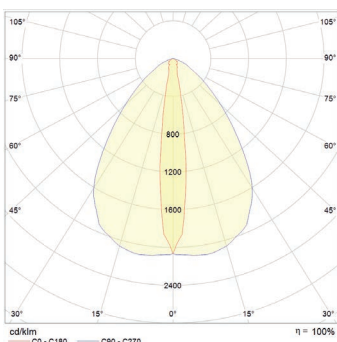

P1L1 (107° x 100°) (PMMA; SATIN)

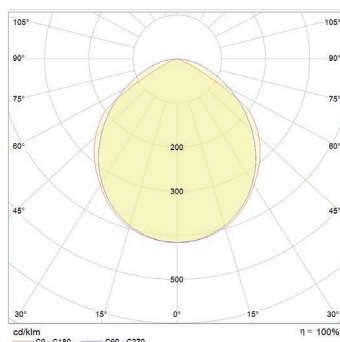

Fast and easy installation

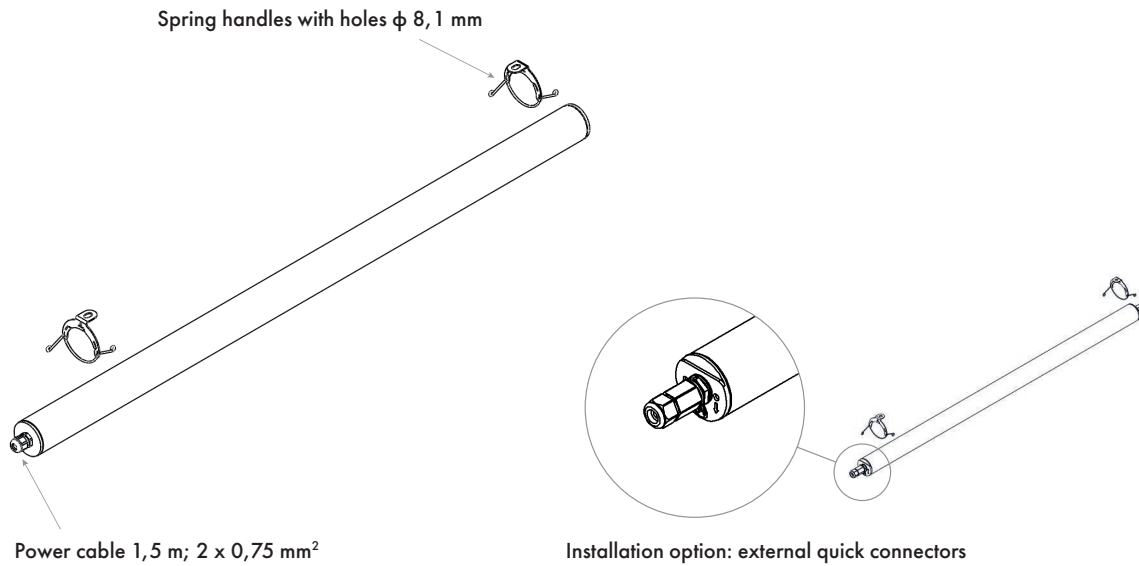

Selene fixture series coding

SL2 a PSP b L1 c TC - O1OM

SL2 Product code – Selene fitting

a Power supply
 „ - “ – 230 VAC
 L – 24V AC/DC

PSP Power supply [W]:
 025 – 25 W
 040 – 40 W
 055 – 55 W
 070 – 70 W

b Power supply control
 N – no control
 Z – 0-10 V
 D – DALI

L Length of luminaire
 K – 610 mm
 S – 1070 mm
 D – 1480 mm

c Ingress Protection Rating
 „ - “ – Power cord 1,5 m; 2 x 0,75 mm²
 A – External quick connector
 B – External quick connectors and through-wiring
 P – Enhanced ingress protection IP69K

T Color temperature of light [K]
 3 – 3000 K
 4 – 4000 K
 5 – 5000 K
 6 – 6500 K

C Color rendering index [CRI]
 8 – Ra > 80
 9 – Ra > 90
 S – Ra > 95

O Optics type:
 P – 119° x 115° – transparent tube PMMA
 R – 119° x 115° – transparent tube PC
 G – 119° x 115° – transparent tube Glass

M 0 – no additional optic
 1 – internal additional optic
 Additional optics type:
 C – 57° x 124° transparent
 D – 33° x 113° transparent
 E – 13° x 79° transparent
 L – 107° x 100° mat

Sample code
SL2-055 N S1-48-P1C1

SL2 Selene luminaire version: SL2
 - Power supply: 230 VAC
055 Power supply: 55 W
N No control
S Length of LED beam: 1070 mm
 - Power cord 1,5 m; 2 x 0,75 mm²
4 Color temperature: 4000 K
8 Minimum CRI: Ra > 80
P Transparent tube PMMA
C Additional optic: C

Technical specification subject to change
 220202V07

Industrial LED fittings with the highest IP ratings

SELENE

   	SELENE SL2 230 VAC 24 V DC/AC	 25/40/ 55/70 W	 L = 50/100/ 150 cm		 3000/4000/ 5000/6500 K	 LM79	
		 260.000 h	 1.2 - 2.4 kg	 IP 67 IP 69K	 80/90/95		
		 .. 173 lm/W	 NS/0-10 V/ DALI	 IK 04 IK 08	 -25° .. +45° C	 OPT. GLASS TUBE	

Company address

TheusLED „TNC INVESTMENTS” Sp. z o.o. Sp. k.
ul. Wałowska 19A, 02-451 Warszawa

Sales and Production

ul. Grabskiego 22, 55-011 Siechnice

E-mail

office@theusled.com

Telephone

+48 71 757 50 67

